

**Circular Solid Dies**

For production of components 3 x D in length.

**Filières Monobloc Rondes**

Pour la réalisation de composants 3 x D en longueur.

**Vollmaterial-Rundschnideisen**

Für Herstellung von Komponenten in 3-facher Durchmesserlänge.

**Terraaja circular maciza**

Para la producción de componentes 3 x D longitudinalmente.

**Неразрезные цилиндрические плашки**

Для нарезания резьбы длиной не более 3 диаметра.



OSG GROUP COMPANY

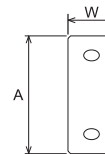

Code
582

Properties

MF	DIN 223	HSS
	DIN 13	6G

P								M				K				Ti			Ni			Cu				N				Syn		
1.1	1.2	1.3	1.4	1.5	1.6	1.7	1.8	2.1	2.2	2.3	2.4	3.1	3.2	3.3	3.4	4.1	4.2	4.3	5.1	5.2	5.3	6.1	6.2	6.3	6.4	7.1	7.2	7.3	7.4	8.1	8.2	8.3
○	○	○	○	○								○	○	○								○	○			○	○					

Size	Pitch	A	W	Code	Size	Pitch	A	W	Code
MF2	0.25	16	5	5820200	MF22	2	55	16	5822220
MF2.2	0.25	16	5	5820220	MF24	1	55	16	5822390
MF2.3	0.25	16	5	5820230	MF24	1.5	55	16	5822400
MF2.5	0.25	16	5	5820250	MF24	2	55	16	5822410
MF2.6	0.25	16	5	5820259	MF25	1	55	16	5822490
MF2.6	0.35	16	5	5820260	MF25	1.5	55	16	5822500
MF3	0.35	20	5	5820300	MF26	1.5	55	16	5822600
MF3.5	0.35	20	5	5820350	MF27	1.5	65	18	5822700
MF4	0.35	20	5	5820390	MF27	2	65	18	5822710
MF4	0.5	20	5	5820400	MF28	1	65	18	5822790
MF5	0.5	20	5	5820500	MF28	1.5	65	18	5822800
MF5	0.75	20	7	5820510	MF28	2	65	18	5822810
MF6	0.5	20	5	5820600	MF30	1	65	18	5822990
MF6	0.75	20	7	5820610	MF30	1.5	65	18	5823000
MF7	0.75	25	9	5820700	MF30	2	65	18	5823010
MF8	0.5	25	9	5820789	MF32	1.5	65	18	5823190
MF8	0.75	25	9	5820790	MF32	2	65	18	5823200
MF8	1	25	9	5820800	MF33	1.5	65	18	5823290
MF9	0.75	25	9	5820890	MF33	2	65	18	5823300
MF9	1	25	9	5820900	MF34	1.5	65	18	5823400
MF10	0.5	30	11	5820989	MF35	1.5	65	18	5823500
MF10	0.75	30	11	5820990	MF36	1.5	65	18	5823590
MF10	1	30	11	5821000	MF36	2	65	18	5823600
MF10	1.25	30	11	5821010	MF36	3	65	25	5823610
MF11	1	30	11	5821110	MF38	1.5	75	20	5823800
MF12	0.75	38	10	5821189	MF39	1.5	75	20	5823890
MF12	1	38	10	5821190	MF39	2	75	20	5823900
MF12	1.25	38	10	5821200	MF39	3	75	20	5823910
MF12	1.5	38	10	5821210	MF40	1.5	75	20	5823990
MF13	1	38	10	5821290	MF40	2	75	20	5824000
MF13	1.5	38	10	5821300	MF40	3	75	20	5824010
MF14	0.75	38	10	5821389	MF42	1.5	75	20	5824190
MF14	1	38	10	5821390	MF42	2	75	20	5824200
MF14	1.25	38	10	5821400	MF42	3	75	20	5824210
MF14	1.5	38	10	5821410	MF44	1.5	90	22	5824400
MF15	1	38	10	5821490	MF45	1.5	90	22	5824490
MF15	1.5	38	10	5821500	MF45	2	90	22	5824500
MF16	1	45	14	5821590	MF45	3	90	22	5824510
MF16	1.5	45	14	5821600	MF48	1.5	90	22	5824790
MF18	1	45	14	5821780	MF48	2	90	22	5824800
MF18	1.5	45	14	5821800	MF48	3	90	22	5824810
MF18	2	45	14	5821810	MF50	1.5	90	22	5824990
MF20	1	45	14	5821990	MF50	2	90	22	5825000
MF20	1.5	45	14	5822000	MF50	3	90	22	5825010
MF20	2	45	14	5822010	MF52	1.5	90	22	5825190
MF22	1	55	16	5822190	MF52	2	90	22	5825200
MF22	1.5	55	16	5822200	MF52	3	90	22	5825210

